



J & H SERIES MOTORS

J Series Motors

Pressure up to 165 Bar / Speed up to 2458rpm
Max Torque 84 Nm

5 Bolt Mounting, 16mm Shaft, 1/4"BSP Ports END

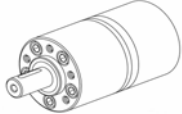

8cc/rev
13cc/rev
20cc/rev
32cc/rev

Item No	Part No		Price £
5034365	M0J05B02B2000A0B	129-0005-002	173.00
5034366	M0J08B02B2000A0B	129-0006-002	175.00
5034367	M0J12B02B2000A0B	129-0007-002	177.00
5034368	M0J19B02B2000A0B	129-0008-002	181.00

2 Bolt Mounting, 16mm Shaft, 3/8"BSP Ports TOP

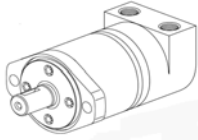

8cc/rev
13cc/rev
20cc/rev
32cc/rev
50cc/rev

Item No	Part No		Price £
5034380	M0J05D02E2000A0B	129-0101-002	182.00
5034381	M0J08D02E2000A0B	129-0102-002	183.00
5034382	M0J12D02E2000A0B	129-0103-002	186.00
5034383	M0J19D02E2000A0B	129-0104-002	189.00
5034396	M0J30D02E2000A0B	129-0410-002	219.00

2 Bolt Mounting, 16mm Shaft, 1/4"BSP Ports END



8cc/rev
13cc/rev
20cc/rev
32cc/rev

Item No	Part No		Price £
5034384	M0J05D02B2000A0B	129-0105-002	182.00
5034385	M0J08D02B2000A0B	129-0106-002	183.00
5034386	M0J12D02B2000A0B	129-0107-002	186.00
5034387	M0J19D02B2000A0B	129-0108-002	189.00

H Series Motors

Pressure up to 165 Bar / Speed up to 1100rpm
Max Torque 520 Nm

2 Bolt SAE A Mounting,
25mm Shaft, 1/2"BSP Ports

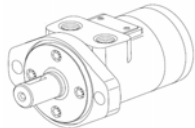

35cc/rev
50cc/rev
60cc/rev
75cc/rev
100cc/rev
120cc/rev
145cc/rev
160cc/rev
185cc/rev
230cc/rev
295cc/rev
370cc/rev

Item No	Part No		Price £
5033290	M0H02A24E2AA0A0J	101-1745-009	149.00
5033267	M0H03A24E2000A0J	101-1660-009	150.00
5033291	M0H04A24E2AA0A0J	101-1746-009	154.00
5033268	M0H05A24E2AA0A0J	101-1661-009	154.00
5033269	M0H06A24E2AA0A0J	101-1662-009	159.00
5033292	M0H07A24E2AA0A0J	101-1747-009	163.00
5033293	M0H09A24E2AA0A0J	101-1748-009	169.00
5033270	M0H10A24E2AA0A0J	101-1663-009	171.00
5033271	M0H11A24E2AA0A0J	101-1664-009	177.00
5033272	M0H14A24E2AA0A0J	101-1665-009	188.00
5033273	M0H18A24E2AA0A0J	101-1666-009	198.00
5033274	M0H23A24E2AA0A0J	101-1667-009	217.00

2 Bolt SAE A Mounting,
1" Keyed Shaft, 1/2"BSP Ports

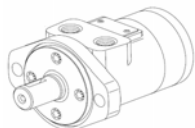

50cc/rev
75cc/rev
100cc/rev
120cc/rev
145cc/rev
160cc/rev
185cc/rev
230cc/rev
295cc/rev

Item No	Part No		Price £
5033235	M0H03A01E2000A0J	101-1596-009	150.00
5033236	M0H05A01E2000A0J	101-1597-009	154.00
5033237	M0H06A01E2000A0J	101-1598-009	159.00
5033282	M0H07A01E2000A0J	101-1719-009	163.00
5033283	M0H09A01E2000A0J	101-1720-009	168.00
5033238	M0H10A01E2000A0J	101-1599-009	170.00
5033239	M0H11A01E2000A0J	101-1600-009	176.00
5033240	M0H14A01E2000A0J	101-1601-009	186.00
5033241	M0H18A01E2000A0J	101-1602-009	198.00



T SERIES MOTORS

T Series Motors

Pressure up to 190 Bar / Speed up to 1021rpm
Max Torque 486 Nm

2 Bolt SAE A Mounting,
25mm Shaft, 1/2"BSP Ports

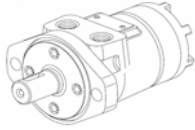

	Item No	Part No	Price £
50cc/rev	5034906	M0T03A24E2000A0A	158-3028-001 196.00
65cc/rev	5034876	M0T04A24E2000A0A	158-1606-001 197.00
80cc/rev	5034851	M0T05A24E2000A0A	158-1463-001 200.00
100cc/rev	5034852	M0T06A24E2000A0A	158-1464-001 204.00
160cc/rev	5034853	M0T10A24E2000A0A	158-1465-001 208.00
195cc/rev	5034854	M0T12A24E2000A0A	158-1466-001 215.00
245cc/rev	5034855	M0T15A24E2000A0A	158-1467-001 223.00
305cc/rev	5034856	M0T19A24E2000A0A	158-1468-001 238.00
370cc/rev	5034857	M0T23A24E2000A0A	158-1469-001 251.00

2 Bolt SAE A Mounting,
1" Keyed Shaft, 1/2"BSP Ports

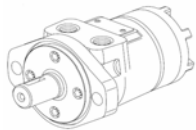

	Item No	Part No	Price £
50cc/rev	5034900	M0T03A01E2000A0A	158-2936-001 196.00
65cc/rev	5034870	M0T04A01E2000A0A	158-1549-001 197.00
80cc/rev	5034828	M0T05A01E2000A0A	158-1435-001 200.00
100cc/rev	5034829	M0T06A01E2000A0A	158-1436-001 204.00
160cc/rev	5034830	M0T10A01E2000A0A	158-1437-001 208.00
195cc/rev	5034831	M0T12A01E2000A0A	158-1438-001 215.00
245cc/rev	5034832	M0T15A01E2000A0A	158-1439-001 223.00
305cc/rev	5034833	M0T19A01E2000A0A	158-1440-001 238.00

T Series Motors (with Brake)

Pressure up to 190 Bar / Speed up to 1021rpm
Max Torque 486 Nm

2 Bolt SAE A Mounting / 1" Keyed Shaft /
5/16"UNC Manifold Ports / 7/16" Case Drain



	Item No	Part No	Price £
36cc/rev	5064082	MTB022AAA01AC00000A0B	185-0201-002 440.00
50cc/rev	5064083	MTB030AAA01AC00000A0B	185-2010-002 445.00
65cc/rev	5064084	MTB040AAA01AC00000A0B	185-2011-002 445.00
80cc/rev	5058049	MTB049AAA01AC00000A0B	185-2012-002 449.00
100cc/rev	5064085	MTB062AAA01AC00000A0B	185-2013-002 453.00
130cc/rev	5064086	MTB080AAA01AC00000A0B	185-2014-002 454.00
160cc/rev	5064087	MTB096AAA01AC00000A0B	185-2015-002 456.00
195cc/rev	5064088	MTB119AAA01AC00000A0B	185-2016-002 463.00
245cc/rev	5064089	MTB149AAA01AC00000A0B	185-2017-002 472.00
305cc/rev	5064090	MTB187AAA01AC00000A0B	185-2018-002 486.00
370cc/rev	5064091	MTB226AAA01AC00000A0B	185-2019-002 499.00

2 Bolt SAE A Mounting / 25mm Keyed Shaft /
1/2"BSP Ports / 1/4"BSP Case Drain



	Item No	Part No	Price £
50cc/rev	5064092	MTB030AAA24AE00000A0B	185-2380-002 437.00
80cc/rev	5060718	MTB049AAA24AE00000A0B	185-2382-002 443.00
160cc/rev	5060720	MTB096AAA24AE00000A0B	185-2385-002 450.00
195cc/rev	5060715	MTB119AAA24AE00000A0B	185-2386-002 458.00
305cc/rev	5060717	MTB187AAA24AE00000A0B	185-2388-002 481.00



2000 SERIES MOTORS

2000 Series Motors

Pressure up to 300 Bar / Speed up to 1042rpm
Max Torque 930 Nm

2 Bolt SAE A Mounting, 80cc/rev
32mm Shaft, 1/2"BSP Ports 305cc/rev

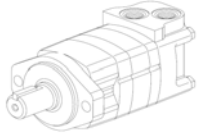

Item No	Part No		Price £
5033588	M0205AC23AG0200000000A0F	104-1498-006	280.00
5033593	M0219AC23AG020000000000F	104-1547-006	310.00

4 Bolt Mounting, 80cc/rev
32mm Shaft, 1/2"BSP Ports 100cc/rev

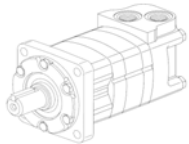

Item No	Part No		Price £
5033570	M0205AH23AG0200000000A0F	104-1384-006	319.00
5033571	M0206AH23AG0200000000A0F	104-1385-006	323.00
5033572	M0208AH23AG0200000000A0F	104-1386-006	325.00
5033573	M0210AH23AG0200000000A0F	104-1387-006	329.00
5033574	M0212AH23AG0200000000A0F	104-1388-006	333.00
5033575	M0215AH23AG0200000000A0F	104-1389-006	338.00
5033576	M0219AH23AG0200000000A0F	104-1390-006	348.00
5033577	M0224AH23AG0200000000A0F	104-1391-006	359.00
5033592	M0230AH23AG0200000000A0F	104-1546-006	402.00

Wheel Mounting, 80cc/rev
1-1/4" Taper Shaft, 1/2"BSP Ports 100cc/rev

Item No	Part No		Price £
5050379	M0205AP03AG0200000000A0F	105-1366-006	318.00
5052694	M0206AP03AG0200000000A0F	105-1379-006	315.00
5063382	M0210AB03AG0200000000A0F	105-1339-006	326.00
5035881	M0212AB03AG0200000000A0F	105-1302-006	331.00
5033706	M0215AB03AG0200000000A0F	105-1183-006	336.00
5033704	M0224AB03AG0200000000A0F	105-1163-006	357.00

Wheel Mounting, 1-1/4" Taper Shaft, 495cc/rev
7/8"SAE O'Ring Ports

Item No	Part No		Price £
5033701	M0230AB03AA010000000000F	105-1152-006	394.00

2000 Series Motors (Two Speed)

Pressure up to 300 Bar / Speed up to 1042rpm
Max Torque 930 Nm

2 Bolt Mounting, 6B Splined Shaft, 80cc/rev
7/8"SAE O'Ring Ports 100cc

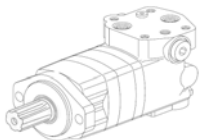

Item No	Part No		Price £
5033626	M2205C05A0B0000A	104-2033-001	633.00
5033627	M2206C05A0B0000A	104-2034-001	635.00
5033628	M2208C05A0B0000A	104-2035-001	638.00
5033629	M2210C05A0B0000A	104-2036-001	643.00
5033630	M2212C05A0B0000A	104-2037-001	647.00
5035888	M2215C05A0B0000A	104-2302-001	653.00

2 Bolt Mounting, 14Tooth Splined Shaft, 305cc
7/8"SAE O'Ring Ports

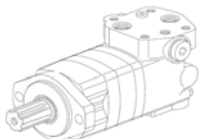

Item No	Part No		Price £
5049843	M2219C04A0B0000A	104-2023-001	665.00



4, 6 & 10,000 SERIES MOTORS

4000 Series Motors

Pressure up to 300 Bar / Speed up to 699rpm
Max Torque 1218 Nm

4 Bolt SAE C Mounting,
40mm Keyed Shaft, 3/4"BSP Ports

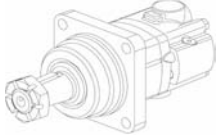

	Item No	Part No		Price £
110cc/rev	5033877	M0407F14C00A0F	109-1184-006	493.00
130cc/rev	5033878	M0408F14C00A0F	109-1185-006	496.00
160cc/rev	5033893	M0410F14C00A0F	109-1227-006	502.00
205cc/rev	5033891	M0412F14C00A0F	109-1224-006	509.00
245cc/rev	5033892	M0415F14C00A0F	109-1225-006	515.00
310cc/rev	5033880	M0419F14C00A0F	109-1189-009	522.00
395cc/rev	5033881	M0424F14C00A0F	109-1190-006	532.00
495cc/rev	5033905	M0430F14C00A0F	109-1267-006	577.00
625cc/rev	5033895	M0438F14C00A0F	109-1233-006	577.00

6000 Series Motors

Pressure up to 300 Bar / Speed up to 866rpm
Max Torque 1875 Nm

4 Bolt SAE C Mounting,
40mm Keyed Shaft, 1"BSP Ports

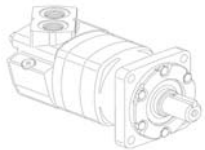

	Item No	Part No		Price £
195cc/rev	5034000	M0612B10C00A0F	112-1094-006	644.00
245cc/rev	5034001	M0615B10C00A0F	112-1095-006	658.00
310cc/rev	5034002	M0619B10C00A0F	112-1096-006	671.00
390cc/rev	5034003	M0624B10C00A0F	112-1097-006	689.00
490cc/rev	5034004	M0630B10C00A0F	112-1098-006	688.00
630cc/rev	5034006	M0638B10C00A0F	112-1111-006	747.00
985cc/rev	5034005	M0660B10C00A0F	112-1099-006	817.00

4 Bolt Danfoss Mounting,
50mm Keyed Shaft, 1"BSP Ports

	Item No	Part No		Price £
310cc/rev	5034012	M0619H21C00A0F	112-1217-006	798.00
390cc/rev	5034013	M0624H21C00A0F	112-1218-006	817.00
490cc/rev	5034010	M0630H21C00A0F	112-1215-006	816.00
630cc/rev	5034011	M0638H21C00A0F	112-1216-006	875.00

Wheel Mounting,
40mm Keyed Shaft, 1"BSP Ports

	Item No	Part No		Price £
490cc/rev	5034038	M0630C10C00A0F	113-1086-006	713.00

10,000 Series Motors

Pressure up to 270 Bar / Speed up to 784rpm
Max Torque 3440 Nm

4 Bolt SAE C Mounting,
2-1/4" Keyed Shaft, 1-5/16"SAE O'Ring Ports

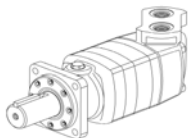

	Item No	Part No		Price £
335cc/rev	5034093	M1020A01A0000C	119-1028-004	1176.00
475cc/rev	5034094	M1029A01A0000C	119-1029-004	1196.00
665cc/rev	5034095	M1040A01A0000C	119-1030-004	1222.00
940cc/rev	5034096	M1057A01A0000C	119-1031-004	1264.00



SPARES FOR MOTORS

Seal Kits

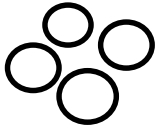

	Item No	Part No	Price £
J Series - 002 Design	5044607	60580-000	32.50
H Series - 009 Design	5044598	60540-000	20.50
T Series - 001 Design	5044604	60564-000	24.50
T Series (Brake) - 002 Design (Viton)	5064081	60566-000	36.50
2000 Series - 006 Design	5044648	61258-000	25.50
2000 Series (2 Speed) - 001 Design	5044651	61267-000	44.00
4000 Series - Front End 006 Design	5044652	61281-000	18.50
4000 Series - Rear End 006 Design	5044640	61234-000	13.00
6000 Series - Front End 006 Design	5044643	61237-000	18.50
6000 Series - Rear End 006 Design	5044644	61238-000	17.50
10000 Series - Front End 004 Series	5045051	6405-000	22.50
10000 Series - Rear End 004 Series	5045052	6406-000	23.50

Port Blocks

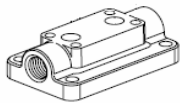

	Item No	Part No	Price £
T Series - 1/2"NPTF Port Block	5034301	123-1007-002	28.50
T Series - 7/8" SAE Port Block	5034302	123-1008-002	47.00