

CHECK VALVES

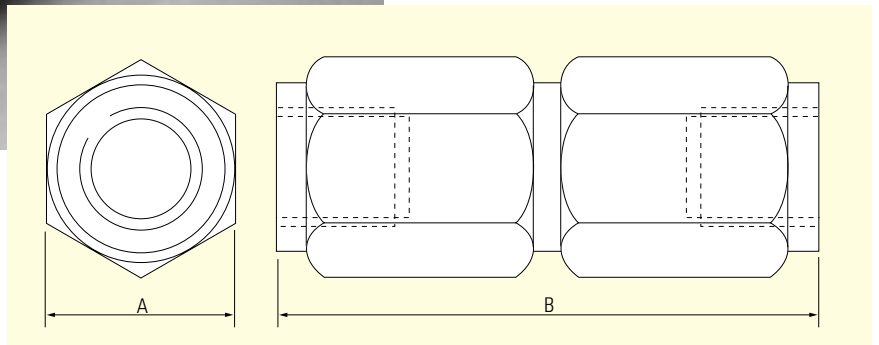

Specification

- Maximum working pressure to 300 bar.
- Steel construction.
- Poppet type.
- 1/8" to 2" BSP ports
- For use with most hydraulic fluids & mineral oils.

Options

Two cracking pressure available, 0.35 & 4.5 bar.

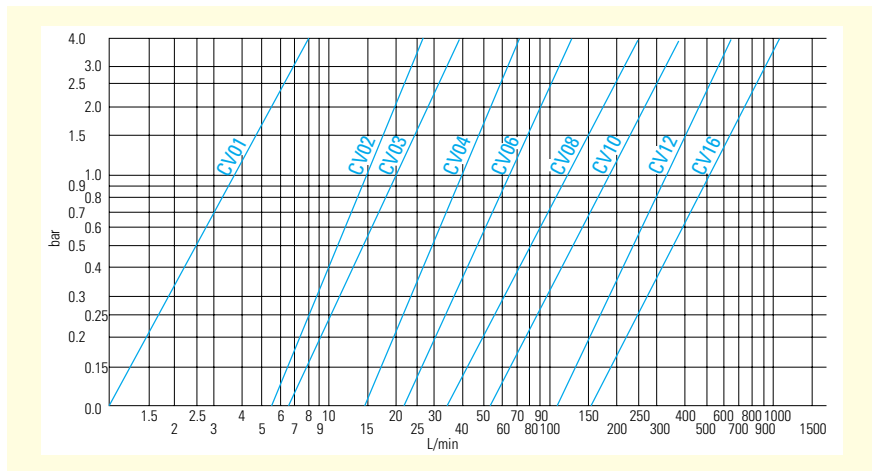

Part number	Rated flow L/min	Max working bar	Dimensions - mm		
			Ports BSP	A	B
CV1A-●	5	350	1/8	14	44
CV2A-●	20	300	1/4	19	60
CV3A-●	30	300	3/8	24	70
CV4A-●	50	300	1/2	30	76
CV6A-●	100	300	3/4	36	90
CV8A-●	150	300	1	45	105
CV10A-●	350	300	1 1/4	55	125
CV12A-●	450	300	1 1/2	65	140
CV16A-●	700	200	2	75	160

Cracking pressure code

Replace ● with appropriate code:

- 05 - 0.35 bar
- 65 - 4.5 bar