

GEAR PUMP FLANGES ELBOW

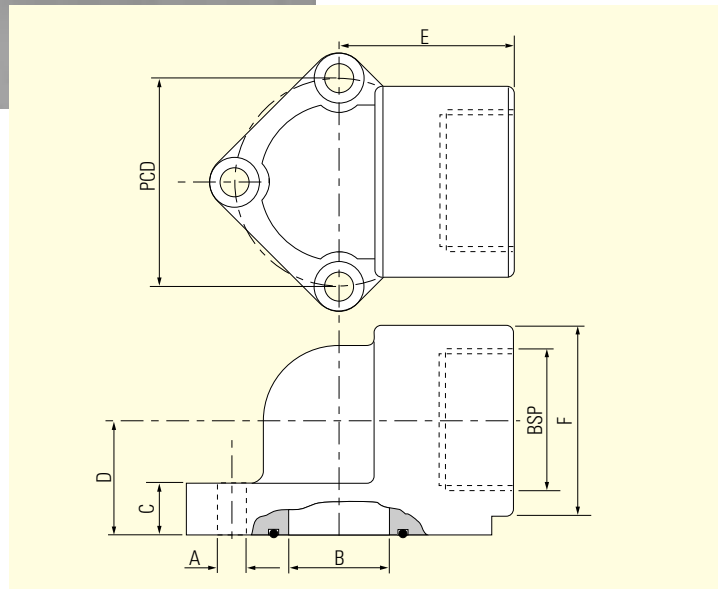

Specification

- Construction - weldable steel.
- aluminium
- Bolts, washers and O ring supplied.

Part number	Material	Max working bar	Dimensions - mm								Bolts thread x length	Number bolts
			Ports BSP	PCD	A	B	C	D	E	F		
LHE06x30S	Steel	300	$\frac{3}{16}$	30.0	6.5	12.0	9.0	17	24	30	M6 x 18	3
LHE08x30S	Steel	300	$\frac{1}{2}$	30.0	6.5	12.0	9.0	17	24	30	M6 x 18	3
LHE08x40S	Steel	300	$\frac{1}{2}$	40.0	8.5	18.0	11.5	22	36	36	M8 x 25	3
LHE12x40S	Steel	300	$\frac{3}{4}$	40.0	8.5	18.0	11.5	22	36	36	M8 x 25	3
LHE12x51S	Steel	300	$\frac{3}{4}$	51.0	10.5	24.0	13.0	26	46	45	M10 x 30	3
LHE16x51S	Steel	300	1	51.0	10.5	24.0	13.0	26	46	45	M10 x 30	3
LHE12x56S	Steel	300	$\frac{3}{4}$	56.0	10.5	24.0	13.0	26	46	45	M10 x 30	3
LHE16x56S	Steel	300	1	56.0	10.5	24.0	13.0	26	46	45	M10 x 30	3
LHE20x62S	Steel	300	$1\frac{1}{4}$	62.0	11.0	31.0	14.0	35	55	55	M10 x 35	3
LHE24x72.5S	Steel	300	$1\frac{1}{2}$	72.5	13.0	38.0	15.0	38	58	62	M12 x 35	3
LHE06x30A	Aluminium	180	$\frac{3}{16}$	30.0	6.5	12.5	26.0	18	30		M6 x 35	3
LHE08x30A	Aluminium	180	$\frac{1}{2}$	30.0	6.5	12.5	26.0	18	30		M6 x 35	3
LHE08x40A	Aluminium	180	$\frac{1}{2}$	40.0	8.5	18.5	31.0	20	40		M8 x 45	3
LHE12x40A	Aluminium	180	$\frac{3}{4}$	40.0	8.5	18.5	31.0	20	40		M8 x 45	3
LHE12x51/56A	Aluminium	180	$\frac{3}{4}$	51/56	10.5	25.0	43.0	26	46		M10 x 60	3
LHE16x51/56A	Aluminium	180	1	51/56	10.5	25.0	43.0	26	46		M10 x 60	3